



FoxAir MAX Low Profile (LP) Series Mobile HVAC 48,000 BTU

MOBILE CONFIGURATION
(Shown in Trolley Configuration)

The FoxCart's FoxAir Max LP is a portable HVAC unit capable of delivering 48,000 BTU of refrigerated air for pre-cooling or maintenance operations, with a minimum ambient temperature of 35°F (1.67°C). With an additional 18 kW 'Heater' option, the FoxAir Max LP can create that comfortable climate year round.

STANDARD FEATURES:

- Sealed Refrigerant System for Unmatched Reliability and Performance
- 1600 CFM Air Movement System
- 14" x 20" x 2" Anti-Microbial Air Filter
- Quick-Connect Collar for Quick and Easy Connection of Air Delivery Hose
- FoxAir Max LP is Mounted on a Low Profile Trolley

INPUT:

Voltage Range	208 - 240, 1Ø or 3Ø 430 - 480, 3Ø 540 - 575, 3Ø 2 Wire, Plus Safety Ground
Frequency	60 Hz ± 10%
Compressor Rated Load	33 A at HV Input 109 A at LV Input
Safety Disconnect	Circuit Breaker ON / OFF

ENVIRONMENTAL:

Refrigerant Type / Qty	R410A - 111 oz
Moisture Protection	IP24
Air Filter	14" x 20" x 2" (Qty 4)
Sound Level	78 dBa

INDICATORS:

Min Ambient Temp	35°F
------------------	------

OPTIONS:

- 18 kW Heater
- Air Delivery Hose (Steel Reinforced 10" Diameter)
15 or 25 Feet (Specify)
50 Feet (Requires Extension Coupling)
- Drain Hose Kit - 50' or 100' Feet (Specify)
- Integral Freeze Protection Switch Prevents Condenser Coil Freeze-Up
- 50', 100', or 150' Foot Input Power Cable (Pigtail - Specify)
- Convenience Outlet - 120VAC (Specify Voltage)

MECHANICAL SPECIFICATIONS:

Size:	See Figure 1 for FoxAir LP
Weight:	885lbs (2,248kg)

(Weight Varies with Options)

OPERATING CONDITIONS:

Modes	Cool or Fan Only
-------	------------------

CAPACITY RATINGS (OUTPUT):

Cooling BTU / Tons	48,000 / 4.0
Heating (Optional)	18 kW
Airflow	1600 CFM
Energy Efficiency Ratings	
SEER	14
EER	12

GENERAL SPECIFICATIONS:

Specifications subject to change without notice

Rev G

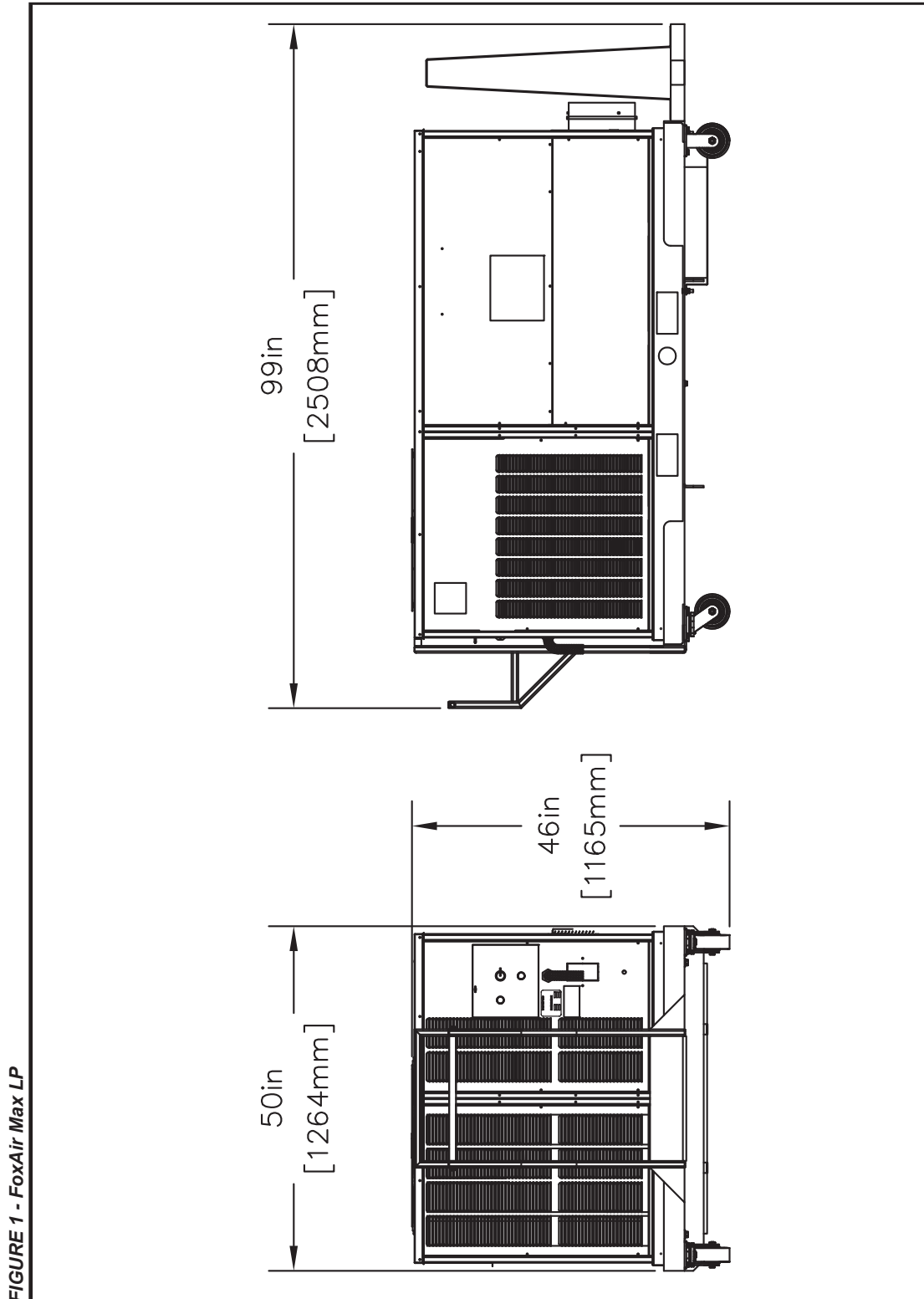

FIGURE 1 - FoxAir Max LP